

PUBLISHED: 11-MAY-2011

2005.0 DISCOVERY 3, 206-05

PARKING BRAKE AND ACTUATION

PARKING BRAKE ACTUATOR - TDV6 2.7L DIESEL (G297741)

REMOVAL AND INSTALLATION

70.35.48	ACTUATOR - ELECTRIC PARKING BRAKE - RENEW	DIESEL	2.00	USED WITHINS	+
70.35.48	ACTUATOR - ELECTRIC PARKING BRAKE - RENEW	PETROL	2.00	USED WITHINS	+

REMOVAL

1.

Using the Land Rover approved diagnostic system, drive the parking brake to the 'mounting position'.
2.

Isolate the parking brake electrical circuit.

■ Remove fuse number 8 from the BJB.
3.

 **WARNING:**

Do not work on or under a vehicle supported only by a jack. Always support the vehicle on safety stands.
4.

Raise and support the vehicle.
4.

Remove the rear wheels and tires.

5.

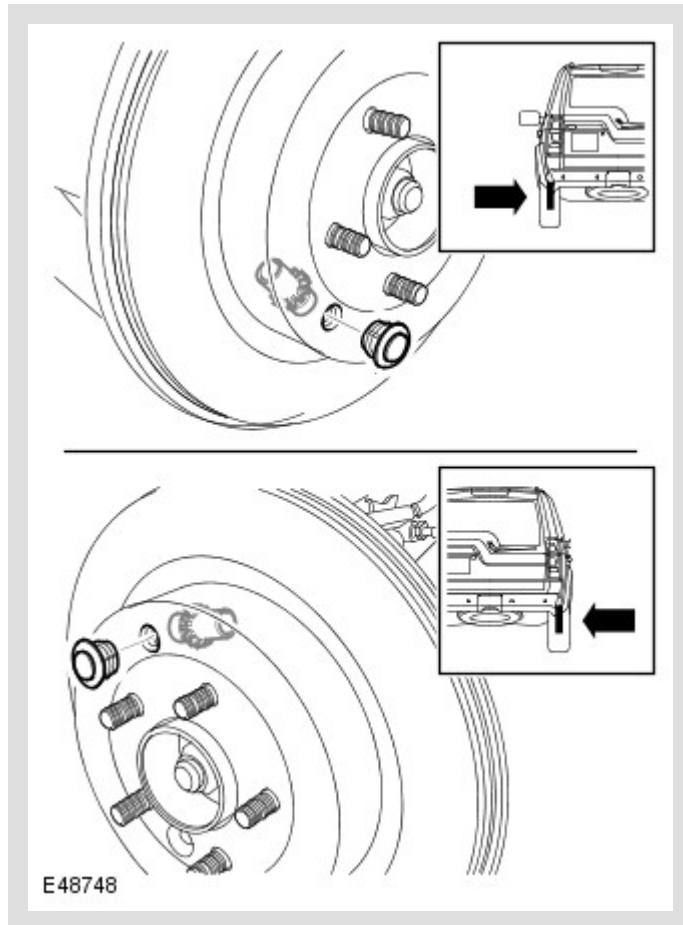

Release the parking brake shoe adjustment.

- Remove the plug from the access hole in the brake disc.
- Using a suitable tool, rotate the brake shoe adjuster to release the adjustment.

6.

⚠ CAUTION:

Do not allow the brake caliper to hang on the brake hose.

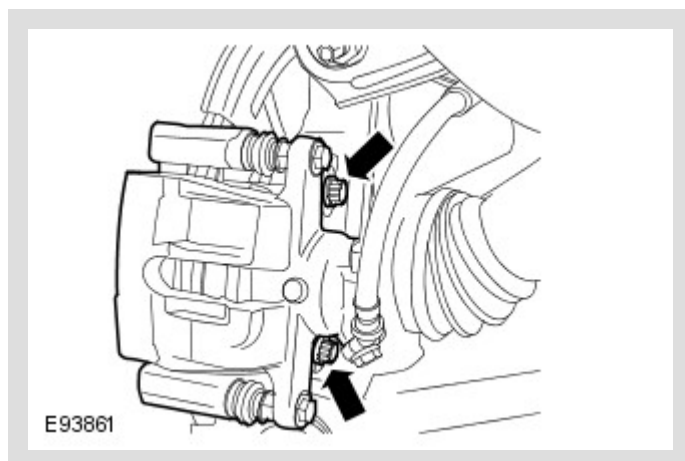

Reposition the RH rear brake caliper.

- Remove the 2 bolts.
- Using a suitable tie strap, support the brake caliper.

7.

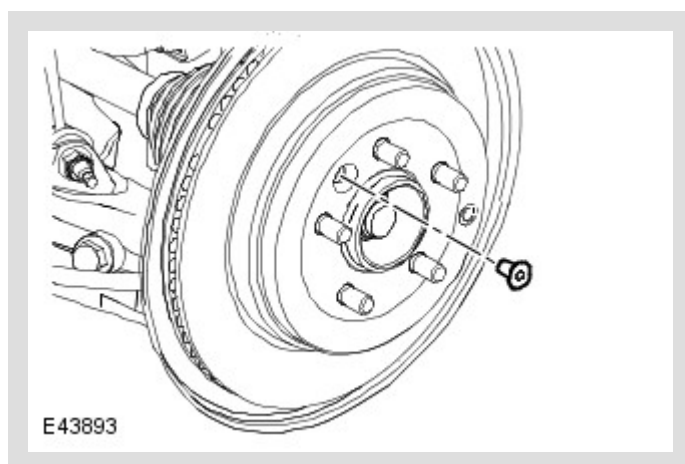

Remove the RH rear brake disc.

- Remove the screw.

8.

⚠ CAUTION:

Do not allow the brake caliper to hang on the brake hose.

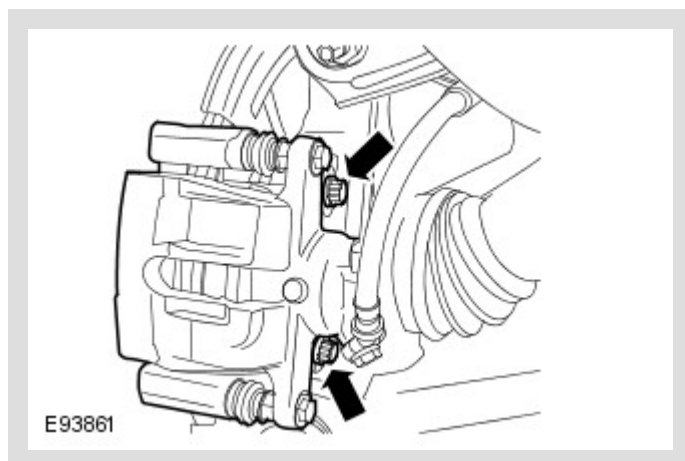

Reposition the LH rear brake caliper.

- Remove the 2 bolts.
- Using a suitable tie strap, support the brake caliper.

9.

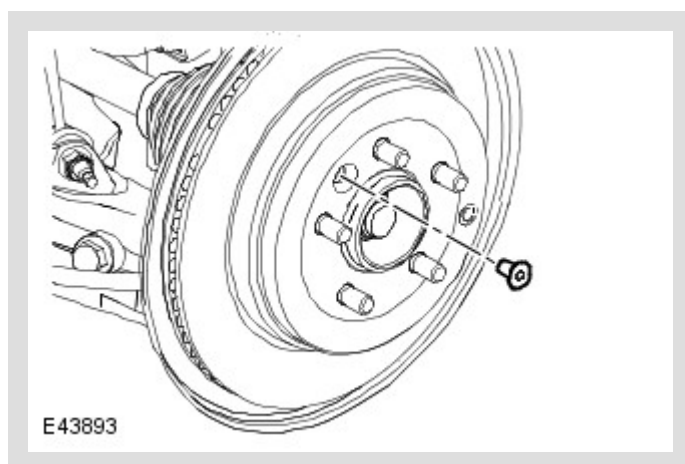

Remove the LH rear brake disc.

- Remove the screw.

10.

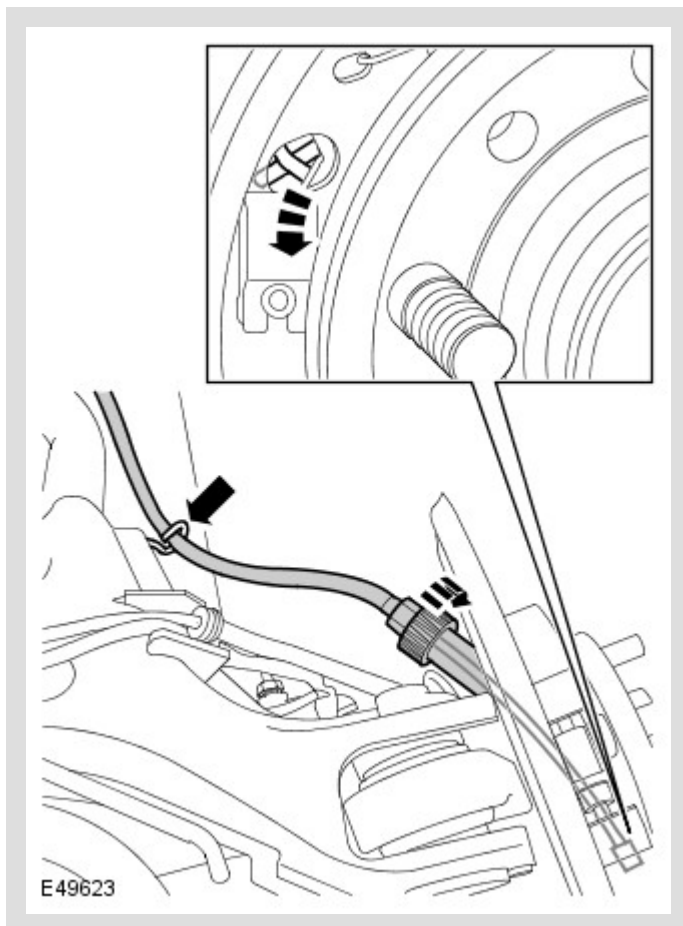

Disconnect both parking brake cables from the wheel hubs.

- Fully loosen the nut.
- Release the cable from the lower arm.
- Disconnect the inner cable from the brake shoe.

11.

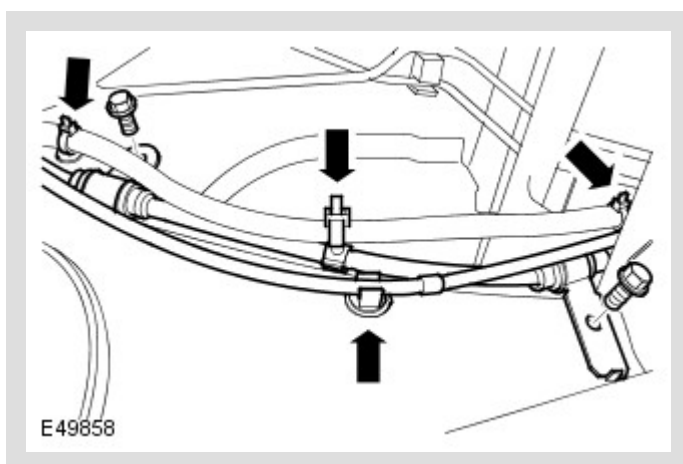

Release the LH parking brake cable.

- Remove the 2 bolts.
- Release the 3 wiring harness clips.
- Release the cable from the clip on the chassis.

12.

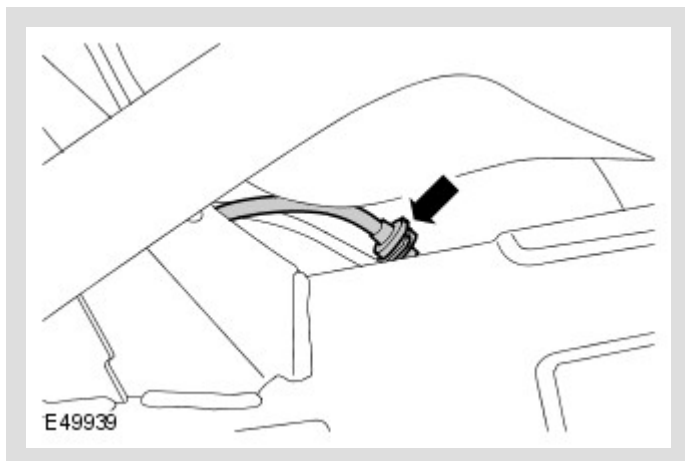

Release the LH parking brake cable.

13.

⚠ CAUTION:

The fuel tank breather line bracket can be easily damaged when releasing it from the chassis.

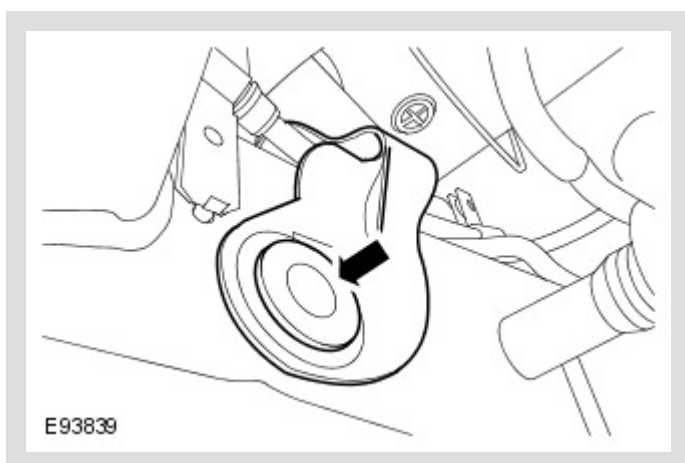

Release the fuel tank breather line bracket.

- Remove the plastic insert.

14.

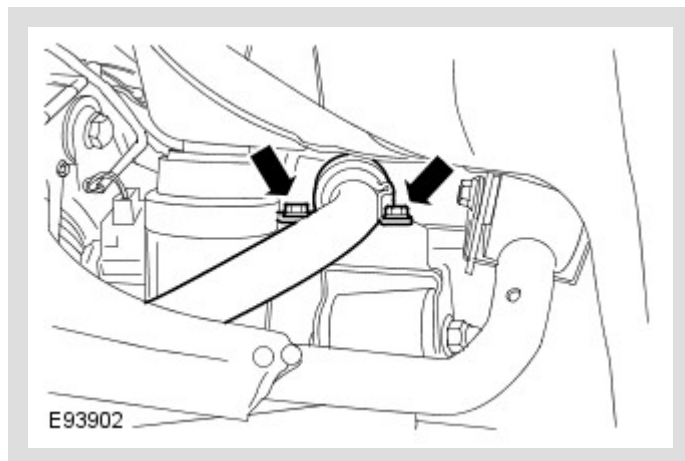

Raise the RH side of the rear stabilizer bar.

- Loosen the 2 bolts.

15.

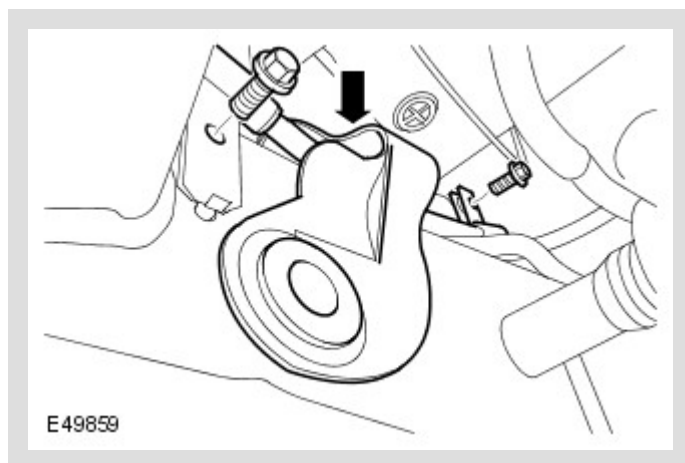

Release the RH parking brake cable.

- Remove the 2 bolts.
- Release the parking brake cable from the 2 pipe clips.
- Release the cable from the clip on the chassis.

16.

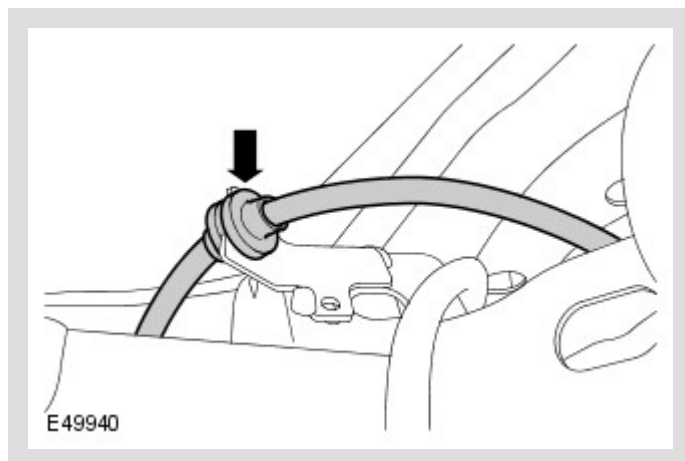

Release the RH parking brake cable.

17.

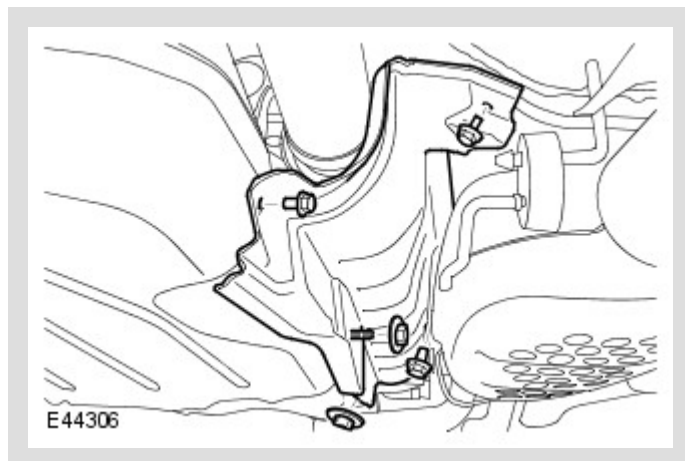

Remove the fuel tank heat shield.

- Remove the 3 bolts and 2 nuts.

18.

⚠ CAUTION:

Inspect the parking brake emergency release cable to body seal and replace if damaged.

△ NOTE:

Note the fitted position of the parking brake emergency release cable to body seal.

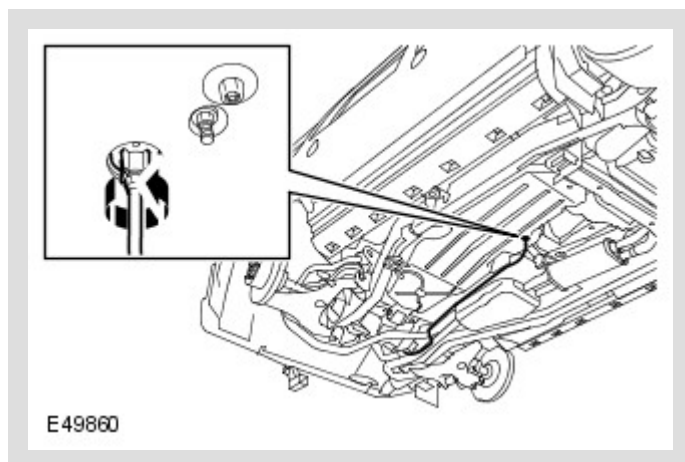

Release the parking brake emergency release cable.

19.

⚠ CAUTION:

Before disconnecting or removing the components, make sure the area around the joint faces and connections are clean. Plug open connections to prevent contamination.

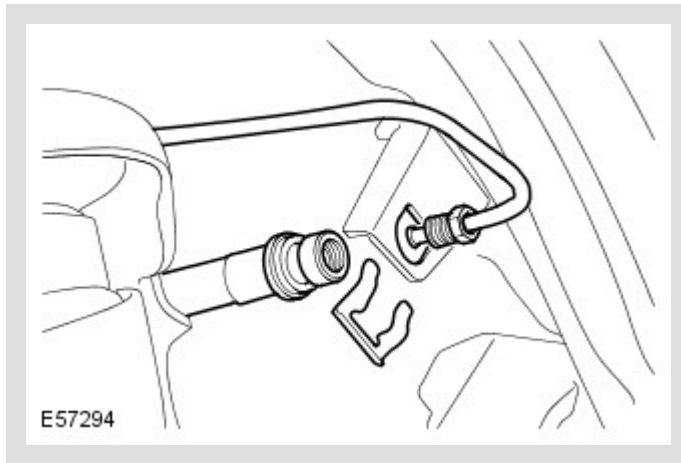

RH side rear: Disconnect the brake line.

- Position an absorbent cloth to collect fluid spillage.
- Disconnect the line union.
- Remove the clip.

20.

△ NOTE:

Note the routing of the parking brake emergency release cable.

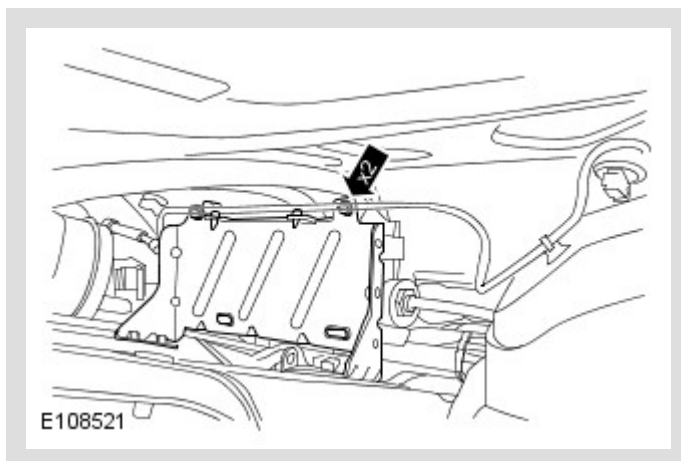

Displace the parking brake actuator and cable assembly.

- Disconnect the electrical connector.
- Remove the 2 nuts.

21.

NOTE:

Brake cable shown removed for clarity.

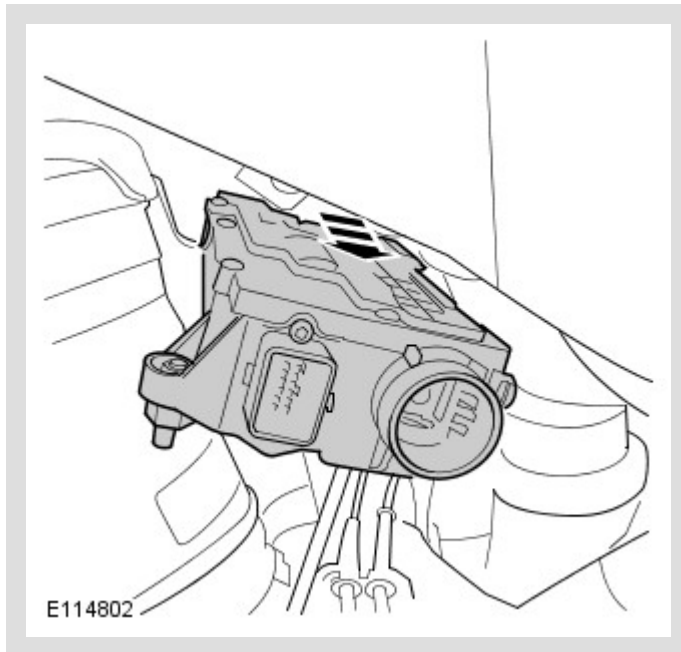

Remove the parking brake actuator and cable assembly.

- Withdraw from the RH rear wheel arch aperture.

INSTALLATION

1.

NOTE:

Note the routing of the parking brake emergency release cable.

Install the parking brake actuator and cable assembly.

- Install the 2 nuts.
- Connect the electrical connector.

2.

NOTE:

Remove and discard the blanking caps.

RH side rear: Connect the brake line.

- Clean the component mating faces.
- Secure the clip.
- Tighten the brake line union to 16 Nm (12 lb.ft).

3.

⚠ CAUTION:

Make sure the parking brake emergency release cable to body seal is installed correctly.

Locate and secure the parking brake emergency release cable.

4.

Install the fuel tank heat shield.

- Tighten the bolts to 6 Nm (4 lb.ft).
- Tighten the nuts to 3 Nm (2 lb.ft).

5.

Secure the fuel tank breather line bracket.

- Install the plastic insert.

6.

Locate and secure the RH parking brake cable.

- Tighten the bolts to 22 Nm (16 lb.ft).
- Secure the parking brake cable to the 2 pipe clips.
- Secure the cable grommet to the integrated body frame bracket.

7.

Locate and secure the LH parking brake cable.

- Tighten the bolts to 22 Nm (16 lb.ft).
- Secure the wiring harness.
- Secure the cable grommet to the integrated body frame bracket.

8.

NOTE:

Make sure that the brake cable circlip is positioned as shown.

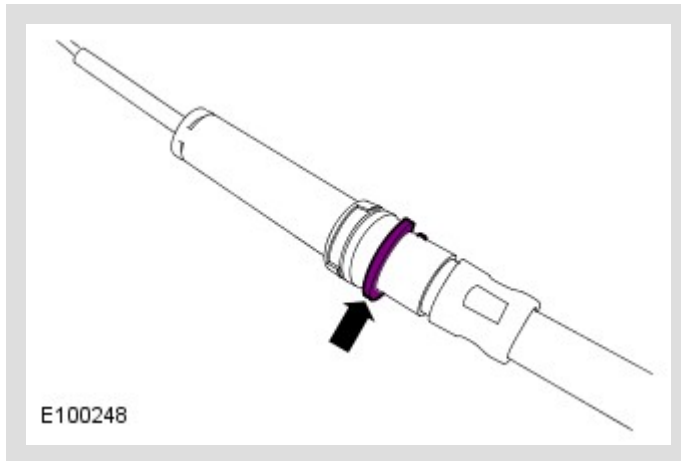

Connect the parking brake cables to the wheel hubs.

- Connect the cable to the brake shoe lever.
- Locate the cable to the backplate.
- Tighten the nut to 8 Nm (6 lb.ft).

9.

CAUTION:

Make sure that the component is clean, free of foreign material and lubricant.

Install the LH rear brake disc.

- Tighten the Torx screw to 35 Nm (26 lb.ft).

10.

Secure the LH rear brake caliper.

- Remove and discard the tie strap.
- Tighten the bolts to 115 Nm (85 lb.ft).

11.

CAUTION:

Make sure that the component is clean, free of foreign material and lubricant.

Install the RH rear brake disc.

- Tighten the Torx screw to 35 Nm (26 lb.ft).

12.

Secure the RH rear brake caliper.

- Remove and discard the tie strap.
- Tighten the bolts to 115 Nm (85 lb.ft).

13. Adjust the parking brake shoes. For additional information, refer to: [Parking Brake Shoe and Lining Adjustment](#) (206-05 Parking Brake and Actuation, General Procedures).

14. Bleed the brake system. For additional information, refer to: [Brake System Bleeding](#) (206-00 Brake System - General Information, General Procedures).

15. Install the wheels and tires.

- Tighten the wheel nuts to 140 Nm (103 lb.ft).

16. Install fuse number 8 into the BJB.

17. Using the Land Rover approved diagnostic system, calibrate the parking brake actuator on an even surface.

18. Apply and release hand brake to confirm operation.

bWhvbGxhbmQYWE7MjAyNS0wMjI0xNVQwNT00ODoyMS4zNTVaQzgyLjc3LjM2LjQ1Qw==