

ST1979M

Installation

NOTE: If a new barrel is being installed, check that number on barrel coincides with number on accompanying key.

1. Push plastic retaining sleeve over barrel until spring loaded peg locks it into position.
2. Install barrel and plastic sleeve assembly to locking sleeve and insert into exterior handle reversing instruction 6.
3. Assemble lock lever components as illustrated and from inside of door panel, install them to barrel assembly with single screw.

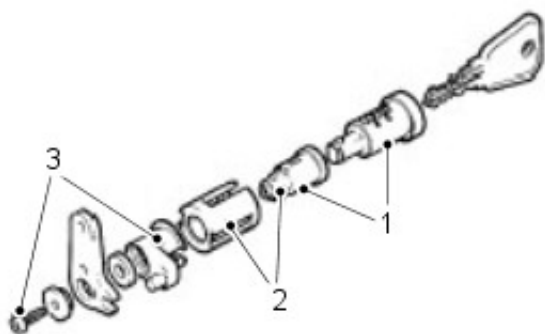

ST1978M

4. Connect operating rod to lock lever and secure with spring clip, reversing instruction 4.
5. Install front door reinforcement panel.
For additional information, refer to: Front Door Reinforcement Panel (501-03, Removal and Installation).
6. Install plastic sheet.
7. Install door trim panel.
For additional information, refer to: Front Door Trim Panel (501-05, Removal and Installation).